

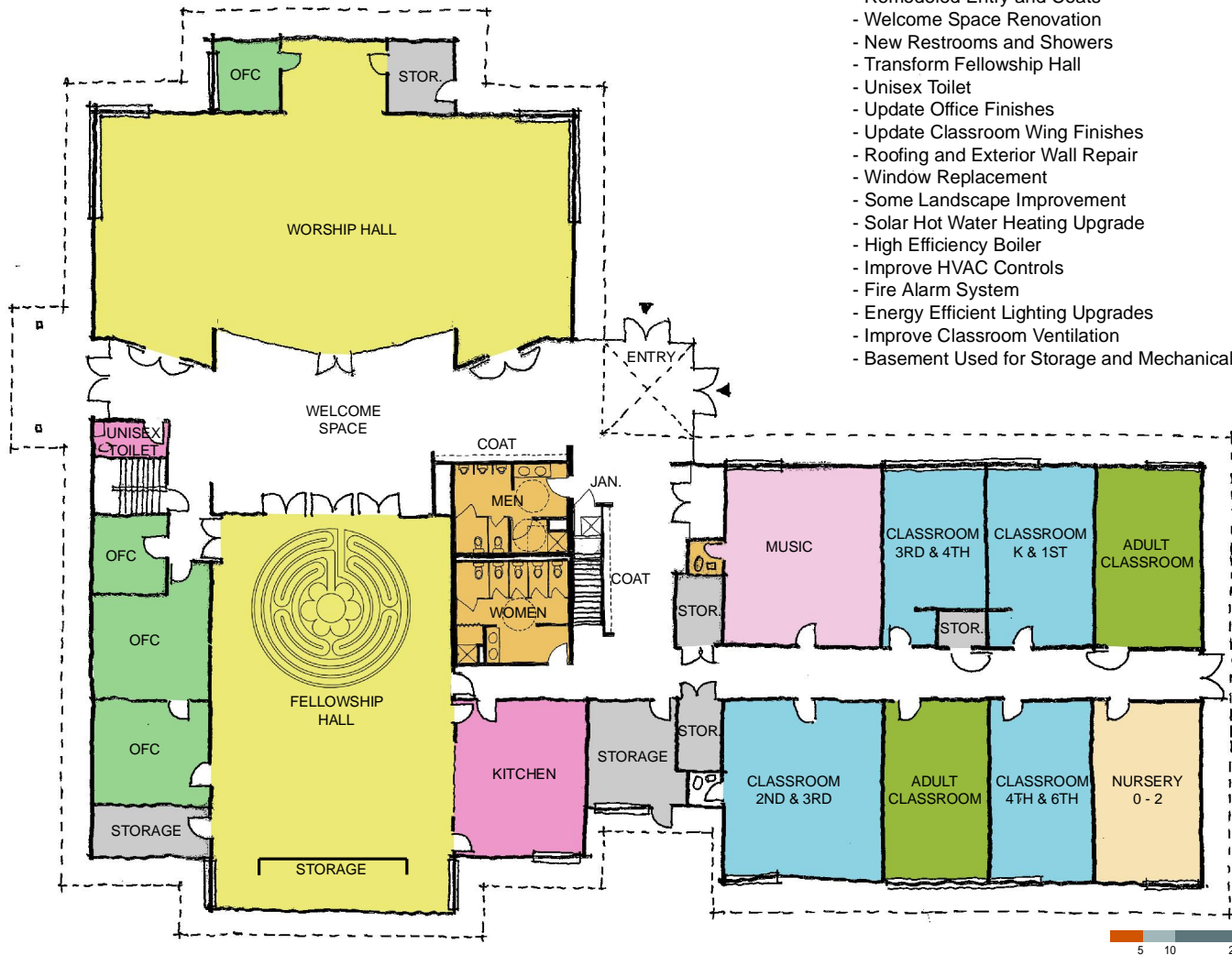

# Floor Plan Options



**FLOOR PLAN OPTION 1** (Budget Cost \$ 800,000)



**FLOOR PLAN OPTION 2A** (Budgeted Cost \$ 1,200,000)

\*ALL OPTION 1 FEATURES PLUS THE FOLLOWING:

- Relocated Office Suite
- Remodel Office Suite into Adult Classroom
- Fully Remodeled Entry Sequence
- Skylights at Reception
- Classroom Reconfigurations

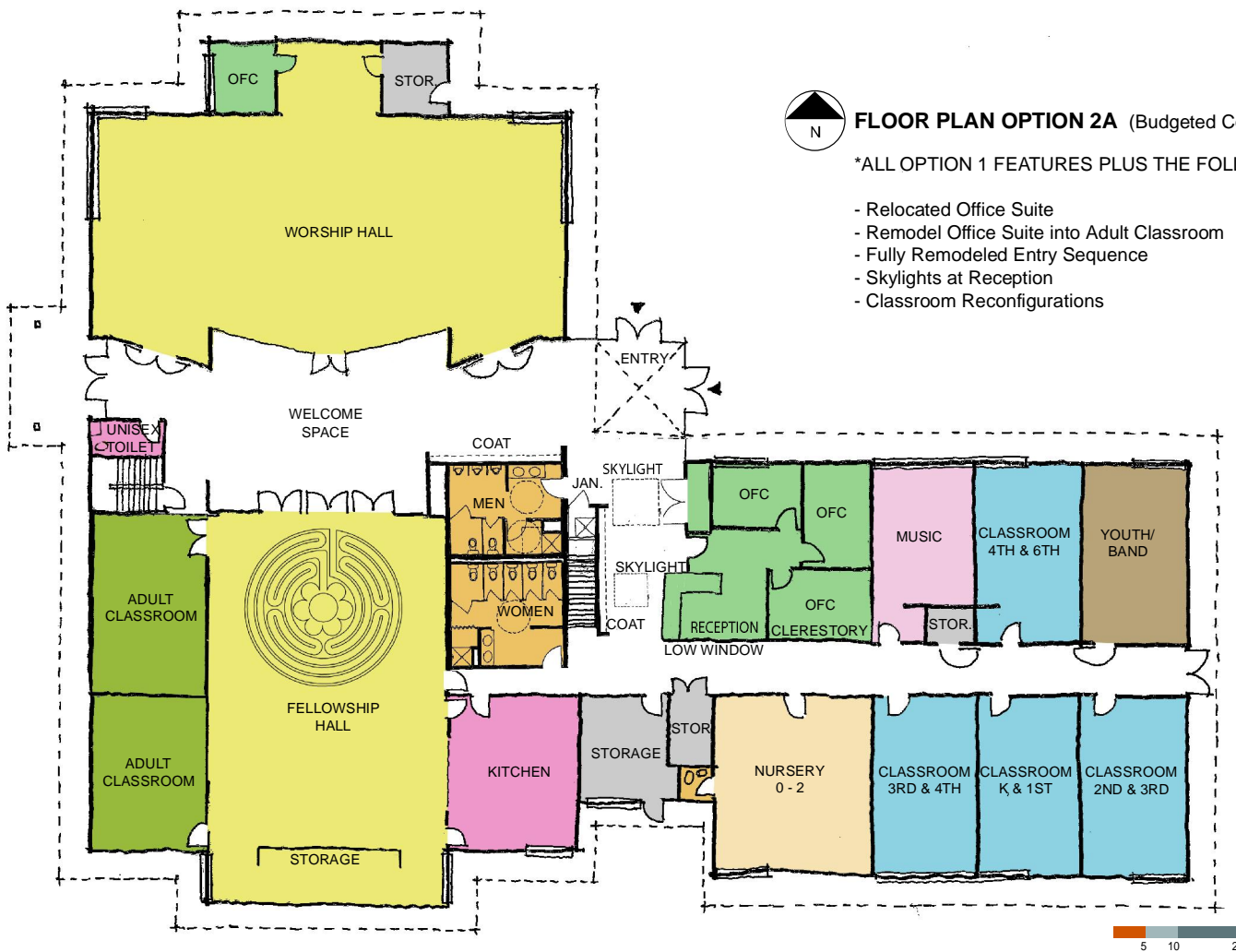

ARCHITECTURE  
ENGINEERING  
INTERIOR DESIGN

